

# Spinnaker pole heel lift system

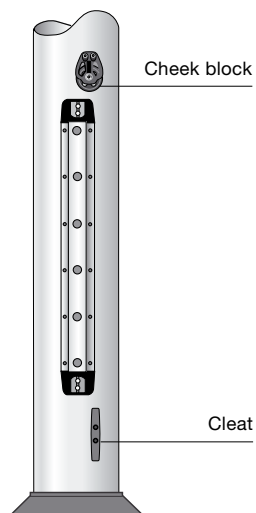

The heel lift system provides effortless spinnaker handling and allows the crew to set the spinnaker in the perfect position.

Tracks not included in the heel lifting system. See page 149.



C175-F246, E122-E206:  
Art. No. 405-001-81

(cleat Art. No. 511-016\*).

C227-F246, E177-E206:

Art. No. 405-001-82 (cleat Art. No. 511-031\*).

C264-F305, E237-E274:

Art. No. 406-001-83 (cleat Art. No. 511-015\*).

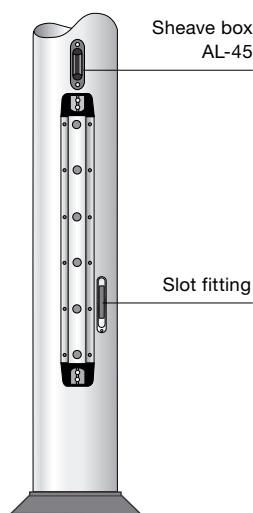

Art. No. 538-508-06.  
Operation from cockpit.

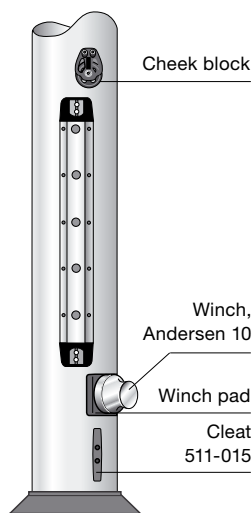

Art. No. 406-001-87.

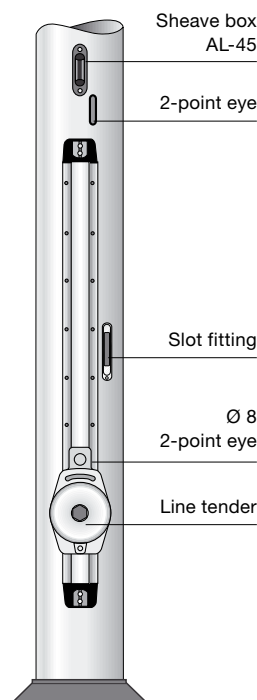

Art. No. 538-508-11.

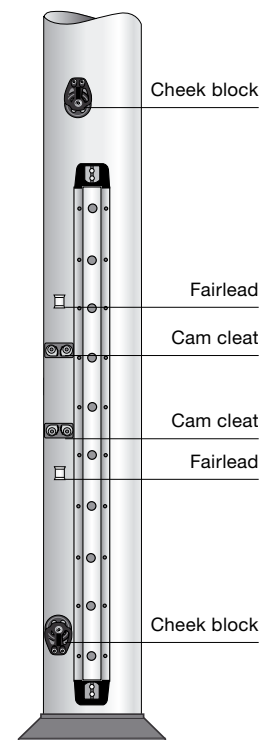

C175-C245:  
Art. No. 405-001-85.  
C264:  
Art. No. 406-001-85.

\*For more information about cleats, see page 48.

## Stowage brackets

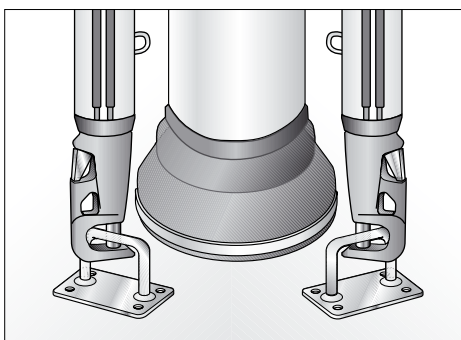

Art. No. 508-145.

Art. No. 508-398.

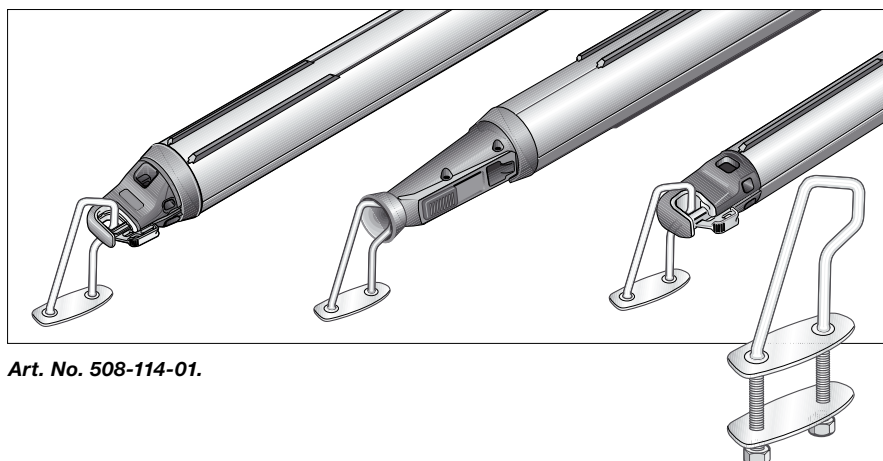

Art. No. 508-114-01.